

A project by

# **PRAJAPATI CONSTRUCTIONS & DEVELOPERS**



## **PRAJAPATI ROYALS**

@Mayuri Nagar, Miyapur

**A life beyond compare.  
orchestrated with utmost care!**





# TYPICAL FLOOR PLAN



## Specifications

### FRAME WORK

R.C.C framed structure.

### SUPER STRUCTURE

**External Walls:** 9" walls with Red brick in cement mortar.

**Internal Walls:** 4" walls with Red brick in cement mortar.

### WALL FINISHES

**Internal Walls:** Luppam finish with Acrylic emulsion of Asian make or equivalent.

**External Walls:** Weather proof paint on putty finish Asian or Equivalent with partial texture finish.

### DOORS & WINDOWS

**Main Door:** Teak wood frames with designer teak wood paneled door polished and finished in melamine with brass hardware as per design.

**Internal Doors:** Teak wood frames with moulded door shutters.

**Windows:** Glazed, UPVC framed, sliding windows with tinted glass with mosquito mesh.

**Ventilators:** UPVC

### KITCHEN

Granite stone cooking platform with steel sink, 2 feet height Granite dado, provision of points for Aqua guard and wet grinder/mixer.

### ELECTRICAL

Concealed copper wiring of Finecab electrification with adequate points of lights, A.C points in each bedroom and T.V point in hall with switches and MCB's of Anchor Panta make.

### T.V & TELEPHONE

Provision of cable and net points in living hall and drawing room.

### SANITARY

Ceramic sanitary ware of CERA. European Wc's & IWC in common toilets. All sanitary pipes are of CPVC of Ashirvad or equivalent make.

### FLOORING

3'X3' Vitrified tiles of reputed make flooring in all rooms & Toilets are in good quality ceramic tiles of Equivalent make. Corridors & Staircase in Granite of approved colours.

### PLUMBING

Super quality CP fittings of brands like CERA or equivalent make. Hot & Cold wall mixers in all toilets, bore water, corporation water in kitchen. All plumbing lines are of CPVC of Ashirvad make.

### RAILINGS

Staircase railings of stainless steel and other railings of MS pipes as per design.

### LIFT

Size (4) passengers capacity lift of Superior brands like Arrow make. Granite clad as per design to Lift fascia walls.

### GENERATOR

Stand by generator of Ashok Leyland (15 KVA) make with elastic accoustic to operate lift, common areas lightings, borewell & sump.

### NOTE

1) GST & Registration fee borne by customer.

2) Persons desirous to alter/modify shall inform the same at the time of booking only & if any change above specifications and change the makes cost borne by customer.

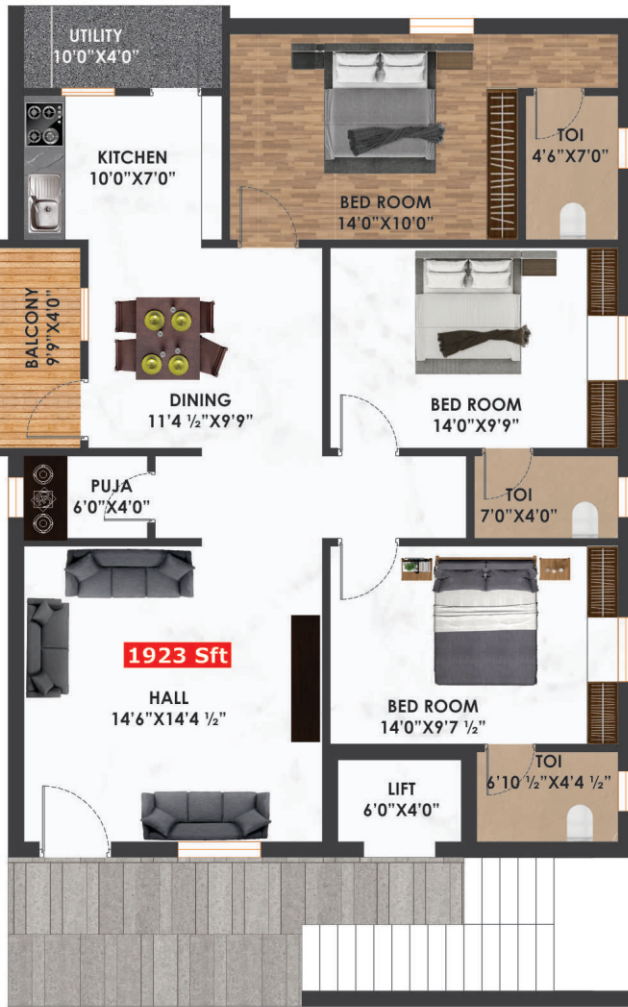

30' WIDE NORTH ROAD

Promoters

## PRAJAPATI CONSTRUCTIONS & DEVELOPERS

Prajapati Nilayam, H.No: 5-6/20/P/A/1,  
Ground Floor, Kakatiya Nagar, Road No. 2A,  
HillCounty Road, Bachupalli, Hyd - 500 090.  
Cell No: **+91 99497 07173, +91 79951 77173**

Completed Projects



Prajapati Happy Homes  
@Ameenpur



Prajapati Heaven @Bachupally



Prajapati Elite  
@KRCR Haritha Vanam Colony, Bachupally.



Prajapati Classic Block - B  
@KRCR Haritha Vanam Colony, Rd No: 5, Bachupally

NOTE : This brochure is only a conceptual presentation of the project and not a legal offering. The promoters reserve the right to make change in the elevation, plan and specifications as deemed fit.